

## PCB Modular Jack Series

KLS12-303-6P PCB Modular Jack 52 Series 1x1 Ports

### MATERIAL

- 1.Housing Material: Glass Filled Polyester UL94V-0 PBT, NYLON
- 2.Housing Color: Black, Gray, Ivory, White or others
- 3.Contact Material: Phosphor Bronze  $\Phi 0.46\text{mm}$
- 4.Plating: Gold plating over nickel. Gold plating thickness 1.5u"/3u"/6u"/15u"/30u"/50u"

### ELECTRICAL

- 1.Current Rating: 1.5 Amp
- 2.Voltage Rating: 125VAC
- 3.Contact Resistance: 30 M $\Omega$  Max.
- 4.Insulation Resistance: 500 M $\Omega$  Min. @ 500VDC
- 5.Withstanding Voltage: 1000VAC RMS 50Hz 1 minute

### MECHANICAL

- 1.Durability : 750 cycles Min.
- 2.PCB Retention pre-solder : 1 LB MIN

### ENVIRONMENTAL

- 1.Storage :-40°C~+80°C
- 2.Operation:-40°C~+70°C

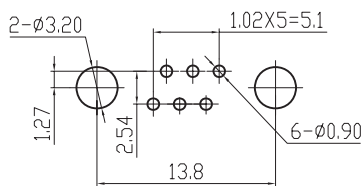
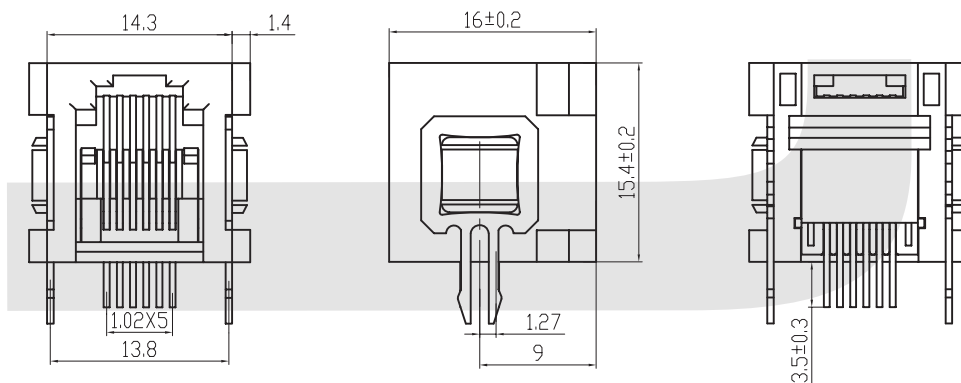

PC Board Layout

## ORDER INFORMATION

KLS12-303 -6P6C- 1x1-1-1-XX-X-X

Part Number	Point NO.	Ports	Iron Peg	Angle	Gold Thickness	Color	Plastic
	6P6C Point 6P4C Point	1x1-1 Ports 1x2-2 Ports 1x3-3 Ports 1x4-4 Ports 1x5-5 Ports 1x6-6 Ports 1x7-7 Ports 1x8-8 Ports	0-Without Iron Peg 1-With Iron Peg	1-90 Angle 2-180 Angle	01-Fu" 02-3u" 03-6u" 04-15u" 05-30u" 06-50u	B-Black G-Gray W-White I-Iv	1-Nylon 2-PBT 3-ABS

## PCB Modular Jack Series

KLS12-303-6P PCB Modular Jack 52 Series 1x2 Ports

### MATERIAL

- 1.Housing Material: Glass Filled Polyester UL94V-0 PBT, NYLON
- 2.Housing Color: Black, Gray, Ivory, White or others
- 3.Contact Material: Phosphor Bronze  $\Phi 0.46\text{mm}$
- 4.Plating: Gold plating over nickel. Gold plating thickness 1.5u"/3u"/6u"/15u"/30u"/50u"

### ELECTRICAL

- 1.Current Rating: 1.5 Amp
- 2.Voltage Rating: 125VAC
- 3.Contact Resistance: 30 M $\Omega$  Max.
- 4.Insulation Resistance: 500 M $\Omega$  Min. @ 500VDC
- 5.Withstanding Voltage: 1000VAC RMS 50Hz 1 minute

### MECHANICAL

- 1.Durability : 750 cycles Min.
- 2.PCB Retention pre-solder : 1 LB MIN

### ENVIRONMENTAL

- 1.Storage :-40°C~+80°C
- 2.Operation:-40°C~+70°C

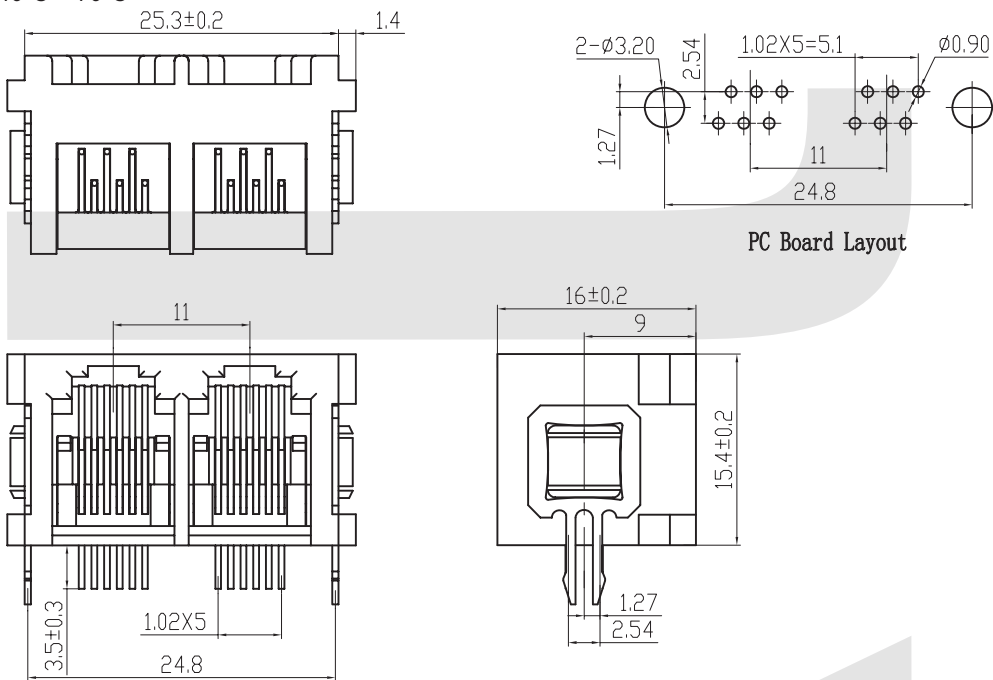

## ORDER INFORMATION

KLS12-303 -6P6C- 1x2-1-1-XX-X-X

Part Number	Point NO.	Ports	Iron Peg	Angle	Gold Thickness	Color	Plastic
	6P6C Point 6P4C Point	1x1-1 Ports 1x2-2 Ports 1x3-3 Ports 1x4-4 Ports 1x5-5 Ports 1x6-6 Ports 1x7-7 Ports 1x8-8 Ports	0-Without Iron Peg 1-With Iron Peg	1-90 Angle 2-180 Angle	01-Fu" 02-3u" 03-6u" 04-15u" 05-30u" 06-50u	B-Black G-Gray W-White I-Iv	1-Nylon 2-PBT 3-ABS

## PCB Modular Jack Series

KLS12-303-6P PCB Modular Jack 52 Series 1x3 Ports

### MATERIAL

- 1.Housing Material: Glass Filled Polyester UL94V-0 PBT, NYLON
- 2.Housing Color: Black, Gray, Ivory, White or others
- 3.Contact Material: Phosphor Bronze  $\Phi 0.46\text{mm}$
- 4.Plating: Gold plating over nickel. Gold plating thickness 1.5u"/3u"/6u"/15u"/30u"/50u"

### ELECTRICAL

- 1.Current Rating: 1.5 Amp
- 2.Voltage Rating: 125VAC
- 3.Contact Resistance: 30 M $\Omega$  Max.
- 4.Insulation Resistance: 500 M $\Omega$  Min. @ 500VDC
- 5.Withstanding Voltage: 1000VAC RMS 50Hz 1 minute

### MECHANICAL

- 1.Durability : 750 cycles Min.
- 2.PCB Retention pre-solder : 1 LB MIN

### ENVIRONMENTAL

- 1.Storage :-40°C~+80°C
- 2.Operation:-40°C~+70°C

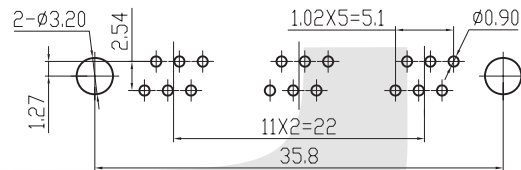
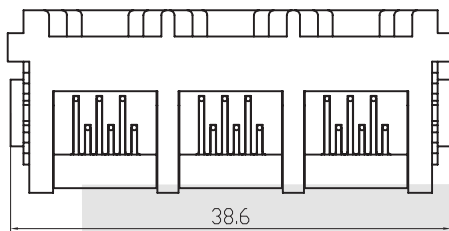
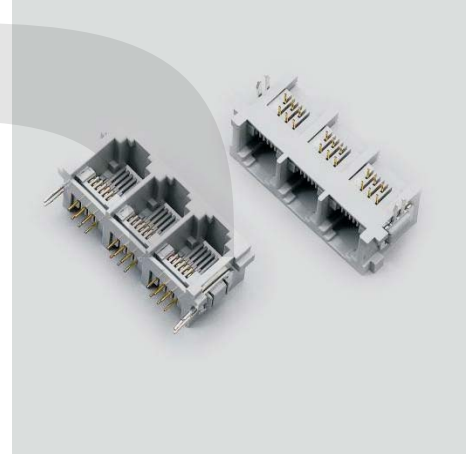

PC Board Layout

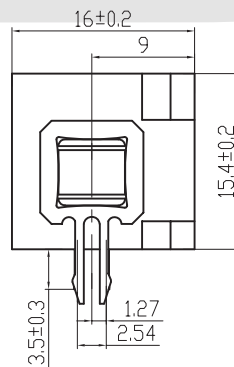
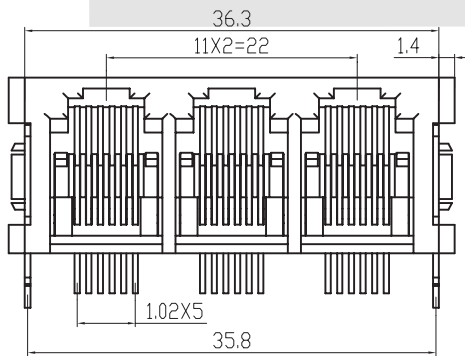

## ORDER INFORMATION

KLS12-303 -6P6C- 1x3-1-1-XX-X-X

Part Number	Point NO.	Ports	Iron Peg	Angle	Gold Thickness	Color	Plastic
	6P6C Point 6P4C Point	1x1-1 Ports 1x2-2 Ports 1x3-3 Ports 1x4-4 Ports 1x5-5 Ports 1x6-6 Ports 1x7-7 Ports 1x8-8 Ports	0-Without Iron Peg 1-With Iron Peg	1-90 Angle 2-180 Angle	01-Fu" 02-3u" 03-6u" 04-15u" 05-30u" 06-50u	B-Black G-Gray W-White I-Iv	1-Nylon 2-PBT 3-ABS

## PCB Modular Jack Series

### KLS12-303-6P PCB Modular Jack 52 Series 1x4 Ports

#### MATERIAL

- 1.Housing Material: Glass Filled Polyester UL94V-0 PBT, NYLON
- 2.Housing Color: Black, Gray, Ivory, White or others
- 3.Contact Material: Phosphor Bronze  $\Phi 0.46\text{mm}$
- 4.Plating: Gold plating over nickel. Gold plating thickness 1.5u" / 3u" / 6u" / 15u" / 30u" / 50u"

#### ELECTRICAL

- 1.Current Rating: 1.5 Amp
- 2.Voltage Rating: 125VAC
- 3.Contact Resistance: 30 M $\Omega$  Max.
- 4.Insulation Resistance: 500 M $\Omega$  Min. @ 500VDC
- 5.Withstanding Voltage: 1000VAC RMS 50Hz 1 minute

#### MECHANICAL

- 1.Durability : 750 cycles Min.
- 2.PCB Retention pre-solder : 1 LB MIN

#### ENVIRONMENTAL

- 1.Storage :-40°C~+80°C
- 2.Operation:-40°C~+70°C

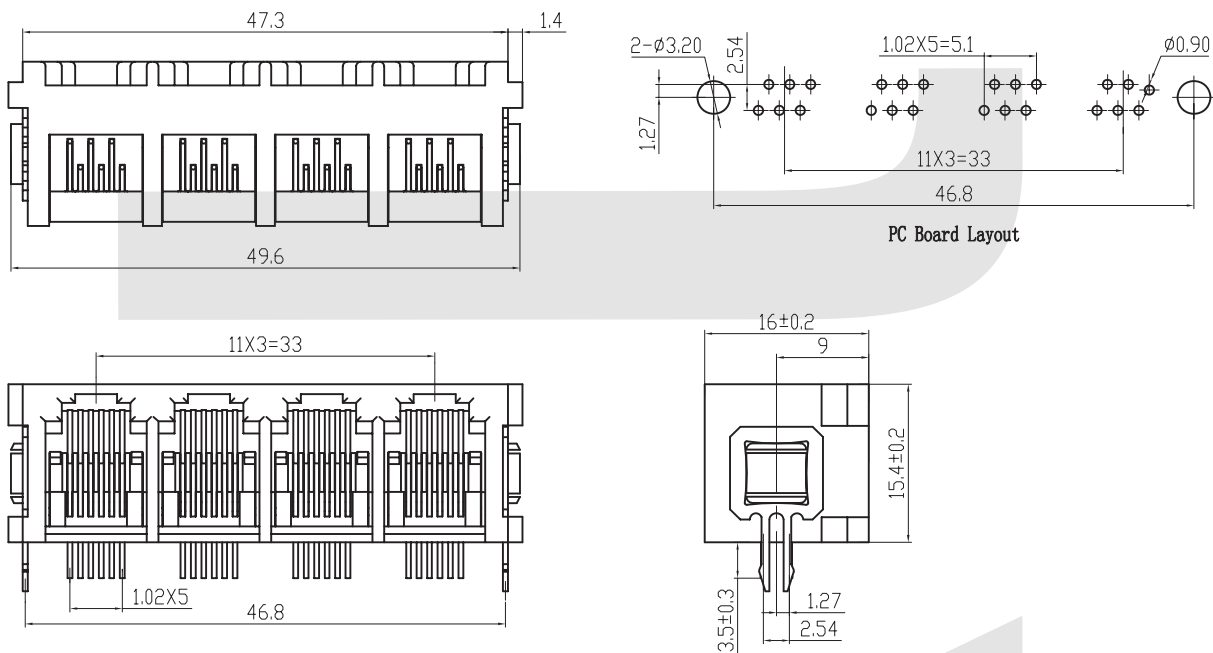

## ORDER INFORMATION

**KLS12-303 -6P6C- 1x4-1-1-XX-X-X**

Part Number	Point NO.	Ports	Iron Peg	Angle	Gold Thickness	Color	Plastic
	6P6C Point 6P4C Point	1x1-1 Ports 1x2-2 Ports 1x3-3 Ports 1x4-4 Ports 1x5-5 Ports 1x6-6 Ports 1x7-7 Ports 1x8-8 Ports	0-Without Iron Peg 1-With Iron Peg	1-90 Angle 2-180 Angle	01-Fu" 02-3u" 03-6u" 04-15u" 05-30u" 06-50u	B-Black G-Gray W-White I-Iv	1-Nylon 2-PBT 3-ABS

## PCB Modular Jack Series

### KLS12-303-6P PCB Modular Jack 52 Series 1x5 Ports

#### MATERIAL

- 1.Housing Material: Glass Filled Polyester UL94V-0 PBT, NYLON
- 2.Housing Color: Black, Gray, Ivory, White or others
- 3.Contact Material: Phosphor Bronze  $\Phi 0.46\text{mm}$
- 4.Plating: Gold plating over nickel. Gold plating thickness 1.5u"/3u"/6u"/15u"/30u"/50u"

#### ELECTRICAL

- 1.Current Rating: 1.5 Amp
- 2.Voltage Rating: 125VAC
- 3.Contact Resistance: 30 M $\Omega$  Max.
- 4.Insulation Resistance: 500 M $\Omega$  Min. @ 500VDC
- 5.Withstanding Voltage: 1000VAC RMS 50Hz 1 minute

#### MECHANICAL

- 1.Durability : 750 cycles Min.
- 2.PCB Retention pre-solder : 1 LB MIN

#### ENVIRONMENTAL

- 1.Storage :-40°C~+80°C
- 2.Operation:-40°C~+70°C

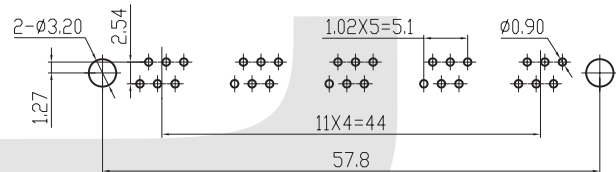

PC Board Layout

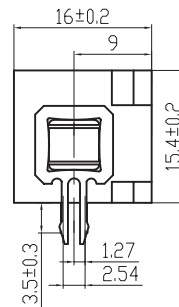
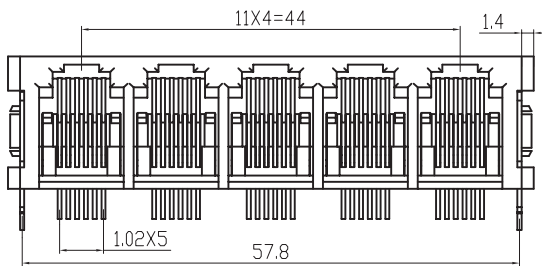

## ORDER INFORMATION

### KLS12-303 -6P6C- 1x5-1-1-XX-X-X

Part Number	Point NO.	Ports	Iron Peg	Angle	Gold Thickness	Color	Plastic
	6P6C Point 6P4C Point	1x1-1 Ports 1x2-2 Ports 1x3-3 Ports 1x4-4 Ports 1x5-5 Ports 1x6-6 Ports 1x7-7 Ports 1x8-8 Ports	0-Without Iron Peg 1-With Iron Peg	1-90 Angle 2-180 Angle	01-Fu" 02-3u" 03-6u" 04-15u" 05-30u" 06-50u	B-Black G-Gray W-White I-Iv	1-Nylon 2-PBT 3-ABS

## PCB Modular Jack Series

KLS12-303-6P PCB Modular Jack 52 Series 1x6 Ports

### MATERIAL

- 1.Housing Material: Glass Filled Polyester UL94V-0 PBT, NYLON
- 2.Housing Color: Black, Gray, Ivory, White or others
- 3.Contact Material: Phosphor Bronze  $\Phi 0.46\text{mm}$
- 4.Plating: Gold plating over nickel. Gold plating thickness 1.5u" / 3u" / 6u" / 15u" / 30u" / 50u"

### ELECTRICAL

- 1.Current Rating: 1.5 Amp
- 2.Voltage Rating: 125VAC
- 3.Contact Resistance: 30 M $\Omega$  Max.
- 4.Insulation Resistance: 500 M $\Omega$  Min. @ 500VDC
- 5.Withstanding Voltage: 1000VAC RMS 50Hz 1 minute

### MECHANICAL

- 1.Durability : 750 cycles Min.
- 2.PCB Retention pre-solder : 1 LB MIN

### ENVIRONMENTAL

- 1.Storage :-40°C~+80°C
- 2.Operation:-40°C~+70°C

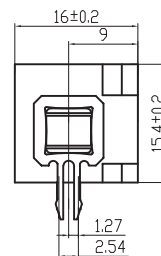
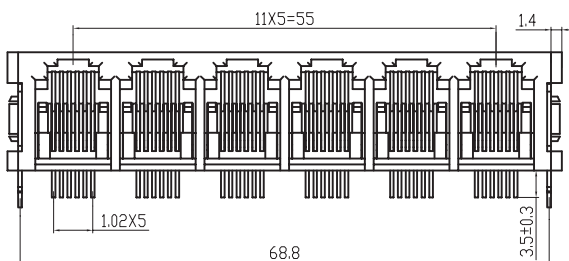
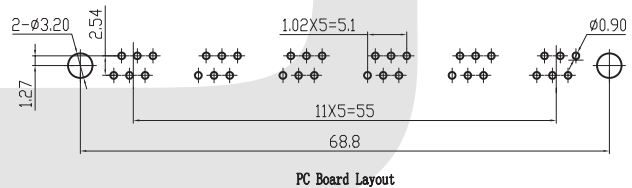
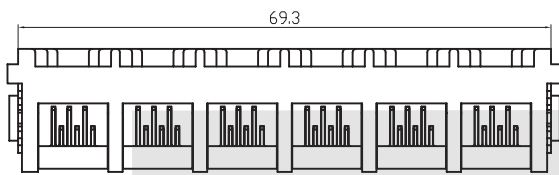

## ORDER INFORMATION

KLS12-303 -6P6C- 1x6-1-1-XX-X-X

Part Number	Point NO.	Ports	Iron Peg	Angle	Gold Thickness	Color	Plastic
	6P6C Point 6P4C Point	1x1-1 Ports 1x2-2 Ports 1x3-3 Ports 1x4-4 Ports 1x5-5 Ports 1x6-6 Ports 1x7-7 Ports 1x8-8 Ports	0-Without Iron Peg 1-With Iron Peg	1-90 Angle 2-180 Angle	01-Fu" 02-3u" 03-6u" 04-15u" 05-30u" 06-50u	B-Black G-Gray W-White I-Iv	1-Nylon 2-PBT 3-ABS

## PCB Modular Jack Series

KLS12-303-6P PCB Modular Jack 52 Series 1x7 Ports

### MATERIAL

- 1.Housing Material: Glass Filled Polyester UL94V-0 PBT, NYLON
- 2.Housing Color: Black, Gray, Ivory, White or others
- 3.Contact Material: Phosphor Bronze  $\Phi 0.46\text{mm}$
- 4.Plating: Gold plating over nickel. Gold plating thickness 1.5u" / 3u" / 6u" / 15u" / 30u" / 50u"

### ELECTRICAL

- 1.Current Rating: 1.5 Amp
- 2.Voltage Rating: 125VAC
- 3.Contact Resistance: 30 M $\Omega$  Max.
- 4.Insulation Resistance: 500 M $\Omega$  Min. @ 500VDC
- 5.Withstanding Voltage: 1000VAC RMS 50Hz 1 minute

### MECHANICAL

- 1.Durability : 750 cycles Min.
- 2.PCB Retention pre-solder : 1 LB MIN

### ENVIRONMENTAL

- 1.Storage :-40°C~+80°C
- 2.Operation:-40°C~+70°C

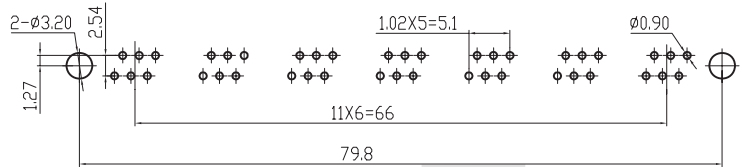

PC Board Layout

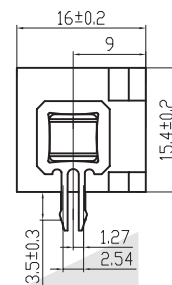
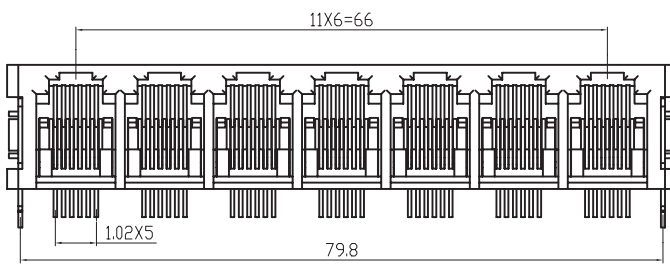
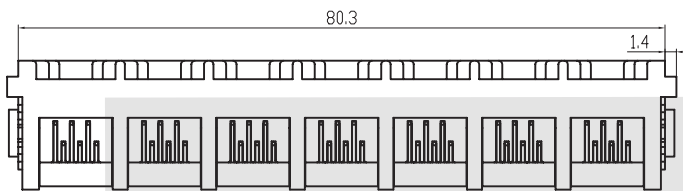

## ORDER INFORMATION

KLS12-303 -6P6C- 1x7-1-1-XX-X-X

Part Number	Point NO.	Ports	Iron Peg	Angle	Gold Thickness	Color	Plastic
	6P6C Point 6P4C Point	1x1-1 Ports 1x2-2 Ports 1x3-3 Ports 1x4-4 Ports 1x5-5 Ports 1x6-6 Ports 1x7-7 Ports 1x8-8 Ports	0-Without Iron Peg 1-With Iron Peg	1-90 Angle 2-180 Angle	01-Fu" 02-3u" 03-6u" 04-15u" 05-30u" 06-50u	B-Black G-Gray W-White I-Iv	1-Nylon 2-PBT 3-ABS

## PCB Modular Jack Series

### KLS12-303-6P PCB Modular Jack 52 Series 1x8 Ports

#### MATERIAL

- 1.Housing Material: Glass Filled Polyester UL94V-0 PBT, NYLON
- 2.Housing Color: Black, Gray, Ivory, White or others
- 3.Contact Material: Phosphor Bronze  $\Phi 0.46\text{mm}$
- 4.Plating: Gold plating over nickel. Gold plating thickness  
1.5u"/3u"/6u"/15u"/30u"/50u"

#### ELECTRICAL

- 1.Current Rating: 1.5 Amp
- 2.Voltage Rating: 125VAC
- 3.Contact Resistance: 30 M $\Omega$  Max.
- 4.Insulation Resistance: 500 M $\Omega$  Min. @ 500VDC
- 5.Withstanding Voltage: 1000VAC RMS 50Hz 1 minute

#### MECHANICAL

- 1.Durability : 750 cycles Min.
- 2.PCB Retention pre-solder : 1 LB MIN

#### ENVIRONMENTAL

- 1.Storage :-40°C~+80°C
- 2.Operation:-40°C~+70°C

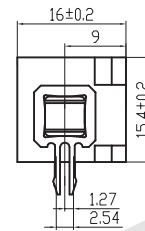
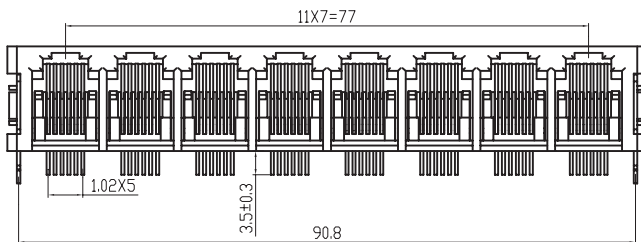
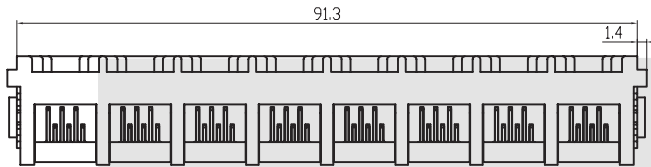
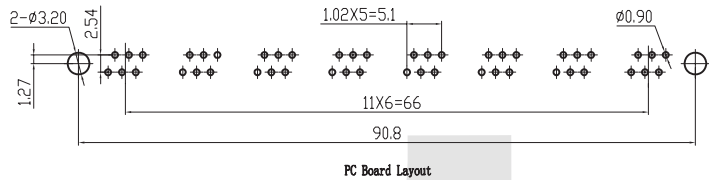

## ORDER INFORMATION

### KLS12-303 -6P6C- 1x8-1-1-XX-X-X

Part Number	Point NO.	Ports	Iron Peg	Angle	Gold Thickness	Color	Plastic
	6P6C Point 6P4C Point	1x1-1 Ports 1x2-2 Ports 1x3-3 Ports 1x4-4 Ports 1x5-5 Ports 1x6-6 Ports 1x7-7 Ports 1x8-8 Ports	0-Without Iron Peg 1-With Iron Peg	1-90 Angle 2-180 Angle	01-Fu" 02-3u" 03-6u" 04-15u" 05-30u" 06-50u	B-Black G-Gray W-White I-Iv	1-Nylon 2-PBT 3-ABS