

Switch Specifications

Circuit	:SPST
Current rating	:50mA
Voltage rating	:12VDC
Dielectric withstanding voltage	:250VAC for 1 minute
Contact resistance	:100mΩ Max. (Initial)
Insulation resistance	:100MΩ Min.
Operating force	:250± 50gf
Total travel	:0.25mm± 0.1mm
Operating life	:100,000 cycles Min
Solder specifications	:256° C for 5 seconds
Function	:Momentary
Operating temperature	:-20° C ~ +70° C

P.C.B. LAYOUT

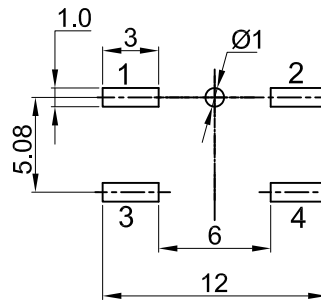

CIRCUIT

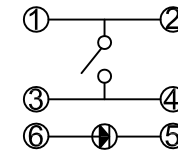

MATERIAL:

Base Frame: Nylon66, UL rated:94 V-2 Min. ;
 Actuator:Actuator: PBT, UL rated:94 V-0 Min. ;
 Terminal: Brass, Silver or Tin plated .

				TOLEANCES		.X± 0.3		.XX± 0.15		ANGLE ± 1°		DIMENSION UNIT mm.	
				VIEWING ANGLE		SCALE	NONE	DATE	2015.03.06	KLS ELECTRONIC CO; LTD		DRAWING NO	
A0	New Issue	2015.03.06	N/A	APPROVED BY	李新超	CHECKED BY	马少飞	DRAWN BY	马少飞				
VER.	CHANGE DESCRIPTION	DATE	ECN NO.										