

REV.	DESCRIPTION	DRAWN	CHECKED	APPROVED
A	NEW RELEASE	LJH 09/22/05'		

NOTES:

- ELECTRICAL CHARACTERISTICS:
 - CONTACT RESISTANCE: 20mΩ Max. INITIAL.
 - DIELECTRIC WITHSTANDING VOLTAGE: 500V AC(rms) FOR 1 MINUTE.
 - INSULATION RESISTANCE: 1000MΩ Min.
- ENVIRONMENT CHARACTERISTICS:
 - OPERATING TEMPERATURE: 0°C~+85°C.
 - STORAGE TEMPERATURE: -20°C~+70°C.

3. PART NUMBER: DS1026-01

4. PRODUCT NUMBER CODE:

DS1026-01 - X X X X X

CONTACTS TYPE
V:VERTICAL TYPE
HOUSING COLOR
B:BLACK
CONTACT PLATING
8: FULL GOLD FLASH
CONNECTOR TYPE
S:SOCKET
No.OF CONTACTS
1*1-1*X
SERIES No.
DS1026-01

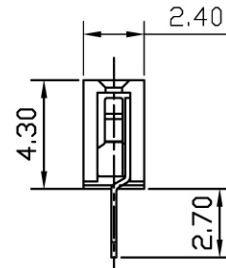
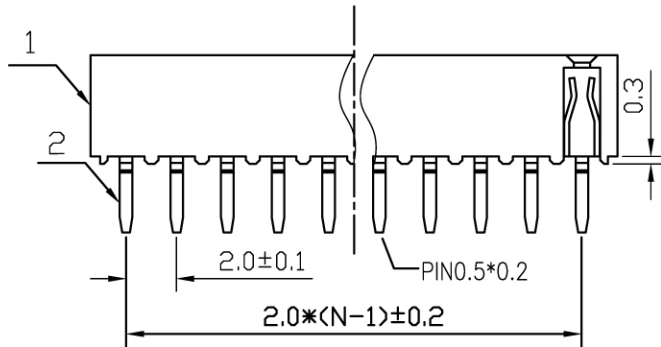
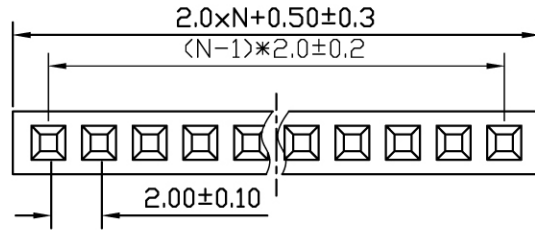

N:NUMBER OF CONTACTS

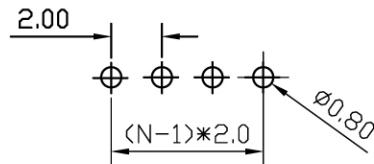

RECOMMEND PCB LAYOUT(TOLERANCE= ± 0.05)

GENERAL TOLERANCE		ANGLE TOLERANCE		PROJECTION		TITLE	FEMALE HEADER PITCH 2.0mm TYPE	
X.	± 0.60	X.	$\pm 5'$	UNITS	mm			
.X	± 0.38	.X	$\pm 3'$	SHEET SIZE	A4	SERIES	DS1026-01 SERIES	
.XX	± 0.25	.XX	$\pm 2'$					

2	CONTACT		COPPER ALLOY		GOLD FLASH	DRAWING TYPE		CUSTOMER	
1	HOUSING		THERMOPLASTIC		UL 94 V-0	SCALE	1:1	SHEET	1 OF 1
ITEM	PART NAME	PART NO.	MATERILAS		FINISHED	DRAWING NO.	C-DS1026-01-XXXXX		

深圳市奥盛利电子有限公司