



REV.	ECN NO.	REVISED	DATE

NOTE:

1.MATERIAL:

- a.HOUSING:PBT
- b.CONTACT: Steel,Brass
- (SURFACE PLATING: +Sn100u"-120u"/ -Si1u")
- SEE ORDERING INFORMATION

2.ELECTRIC:

- a.CONTACT RESISTANCE: 30 MILLIOHMS MAX
- b.INSULATION RESISTANCE: 1000 MEGA OHMS MIN
- c.DIELECTNIC VOLTAGE: 500V AC ONE SEC LEVEL
- d.OPERATING TEMPERATURE: -25°C~ +85°C

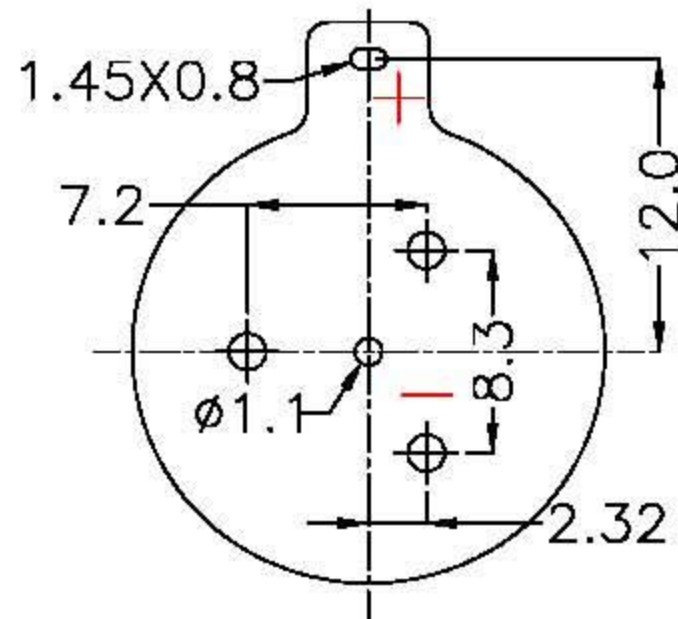
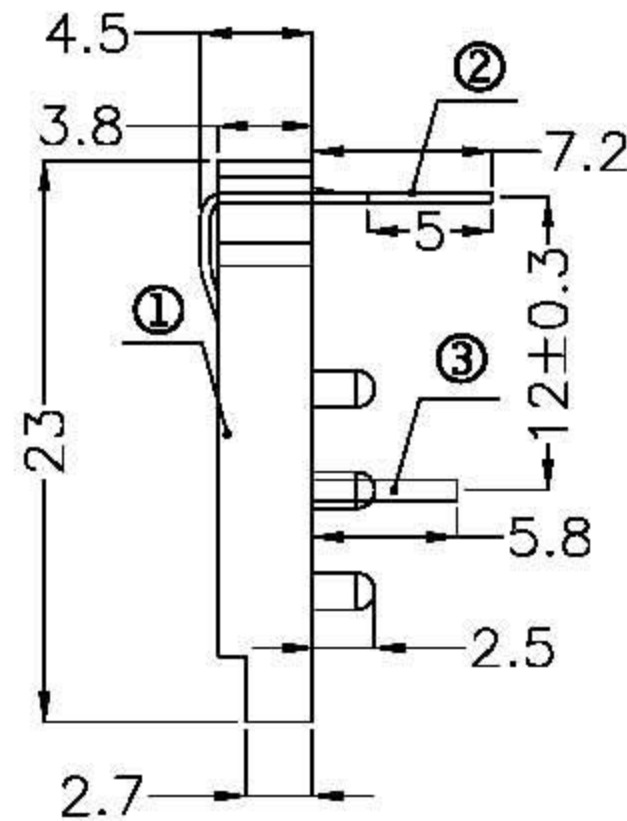
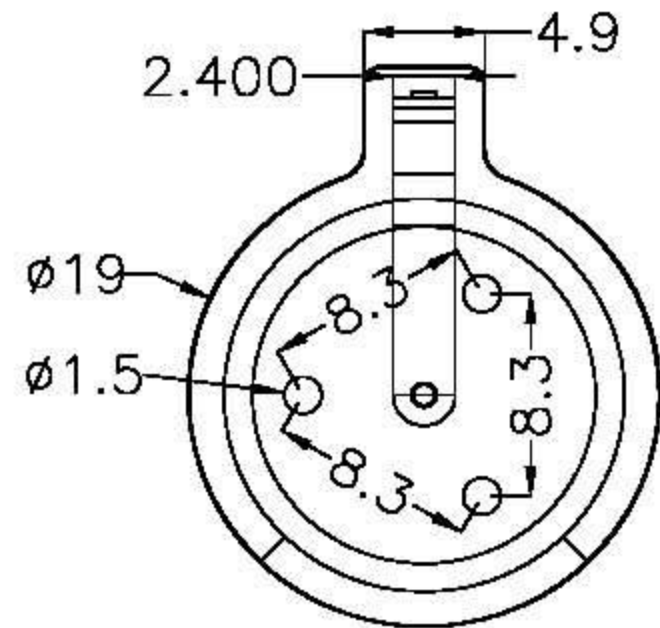

PCB Layout Diagram
Top View

ORDERING INFORMATION

BS-16-A***003

电池座系列

BS-16系列

DIP 90° TYPE

PLATING:

- A-Au1U"
- J-Ni100U"~120U"
- K-Sn100U"~120U"
- M-Si1U"~Ni10U"

MATERIAL:

- 1A-PBT BLACK
- 1B-PA66 BLACK
- 2A-PPA BROWN
- 2B-PPA BLACK
- 3A-PPS BROWN
- 3B-PPS BLACK
- 4A-LCP WHITE
- 4B-LCP BLACK



BS-16-A1AKM003

UNLESS OTHERWISE SPECIFIED TOLERANCES		GREAT POWER			
DECIMALS:	ANGLES:	DSND	YangFeng	DATE	2018-12-14
X : ±0.30	X : ±1°	CHKD	ZhouRuicai	DATE	2018-12-14
X.X : ±0.25	X.X : ±0.5°	APVD	XueShunyong	DATE	2018-12-14
X.XX : ±0.20		WEIGHT: 1.25g		SCALE: 2:1	SIZE: A4
X.XXX : ±0.10		SHEET 1 OF 1		VIEW:	
		UNIT: mm	REV.: A/0	OBJECT: MY	TITLE: BS-1620-1 DIP 正极镀锡, 负极镀银
		PART NO.:		BH600-GP	
		DRAW NO.:		WD-CP-0037	

3	TERMINAL(-)	1	Brass, T=0.85mm	Silver plating and nickel plating
2	TERMINAL(+)	1	Steel, T=0.40mm	Sn-Plating
1	HOUSING	1	PBT	BLACK
NO.	PART NAME	Q'TY	MATERIAL	PLATING & COLOR