

3215(1206) Series

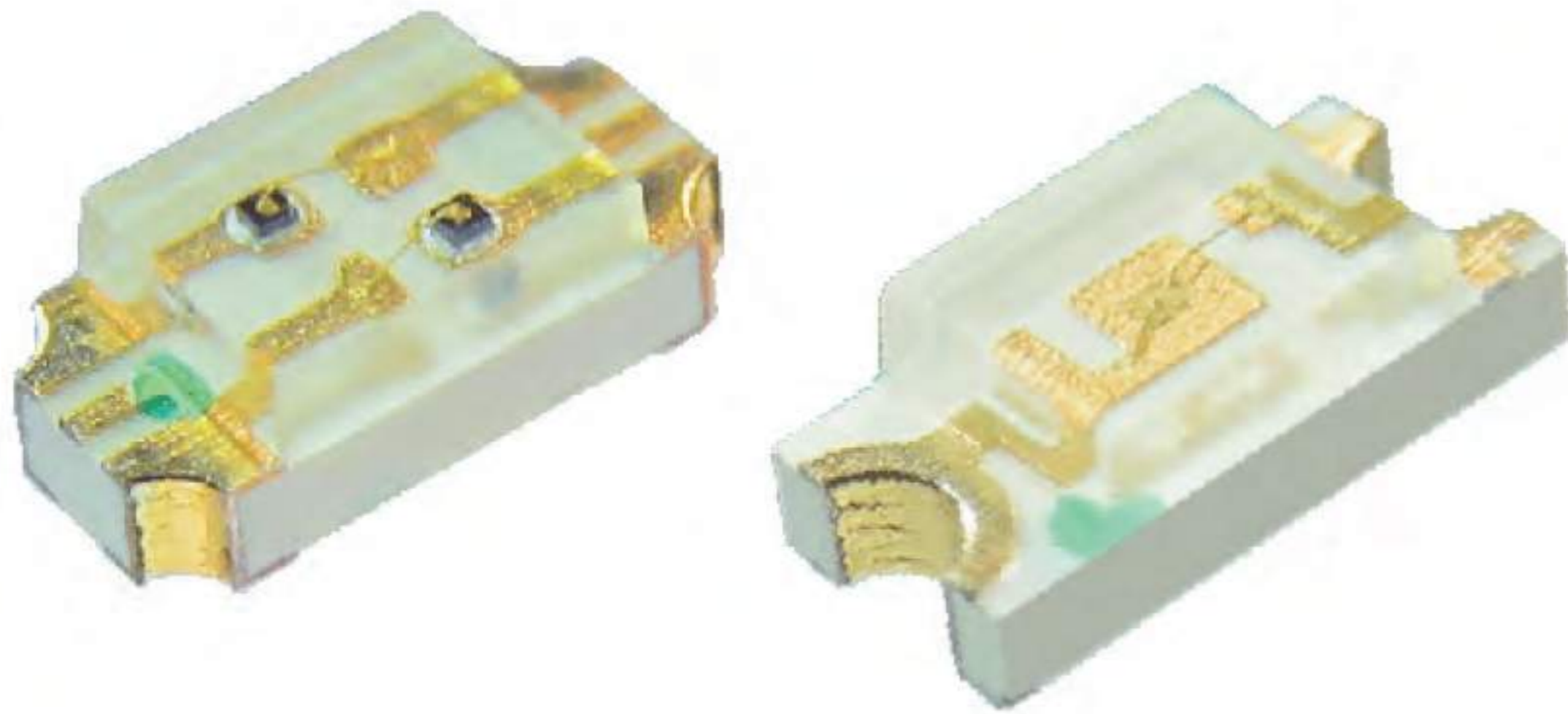

3215 Series

Features:

- Color: red, orange, yellow, green, blue and white.
- Features: small size, high light intensity, wide viewing angle, good reliability and long lifespan.
- Suitable for unleaded reflow soldering process.
- Environment-friendly products and complied with ROHS.
- Mainly used for display and sign indication.

Absolute Maximum Ratings:

Parameter	Symbol	Rating
Forward Current	I_F	25mA
Pulse Forwards Current	I_{FP}	100mA
Reverse Voltage	V_R	5V
Working Temperature	T_{OPR}	-30~+85°C
Storage Temperature	T_{STG}	-40~+100°C

• Plus Width ≤ 0.1ms, Duty Ratio ≤ 1/10

Outline Dimensions/ Unit: mm

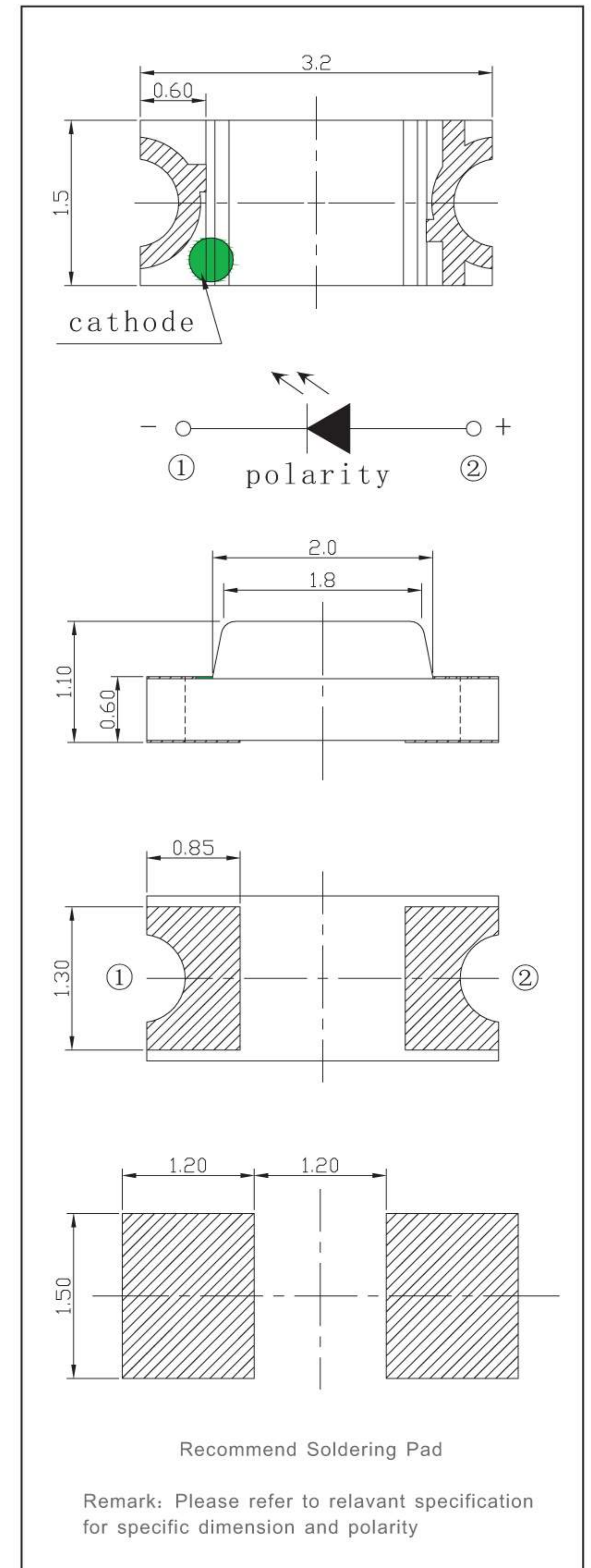

Tolerance: ±0.1mm

Parameter/ $T_a=25^\circ\text{C}$:

Part Number	Color	I_F (mA) TEST	λ_D (nm)/XY Typ.	I_V (mcd) Typ.	V_F (V)	
					Typ.	Max
FC-3215SXX-620D08	Red	20	620	135	2.0	2.6
FC-3215YOXK-600H08	Orange	20	602	180	2.0	2.6
FC-3215YXK-585F08	Yellow	20	590	120	2.0	2.6
FC-3215GHK-570A08	Yellowish Green	20	572	45	2.0	2.6
FC-3215UGK-520D	Green	20	520	600	3.0	3.6
FC-3215BXK-465D	Blue	20	470	120	3.0	3.6
FC-3215SQGEK(Bi-color)	Red	20	620	180	2.0	2.6
	Yellowish Green	20	572	50	2.0	2.6