

1
RoHS Compliance

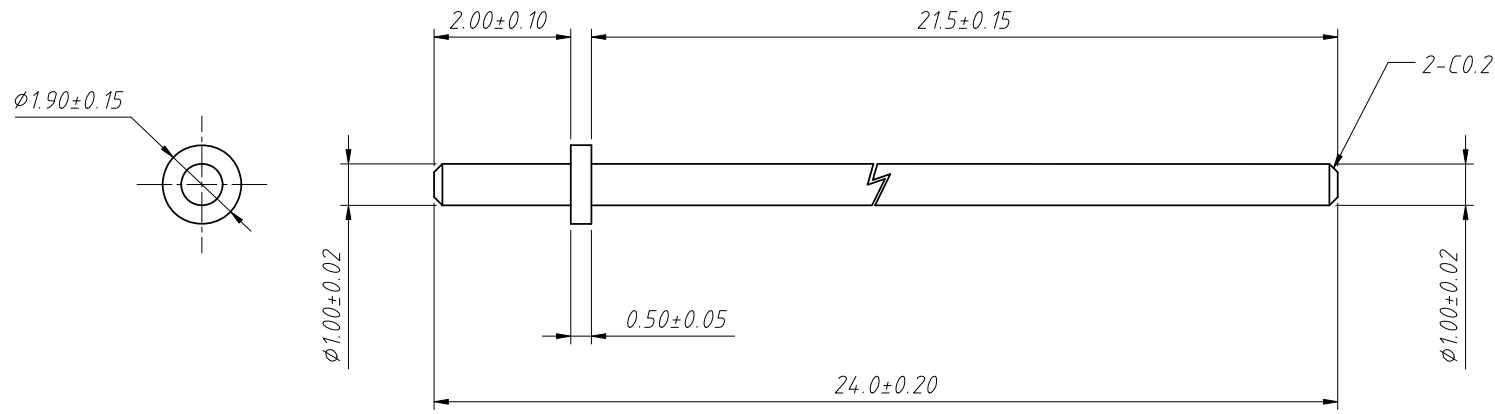

- Technical Requirements:**
1. Material: Brass C3604
 2. External surface finish Ra1.0, no front and burr allowed; The cutting point shall not exceed 0.03mm.
 3. Tin plating after bending.
 4. Black, yellow, fog and other undesirable phenomena are not allowed.

- QC operating standard:**
1. Random inspection shall be conducted every 2 hours. If 1 PC is found to be defective, another 5pcs shall be taken for inspection.
 2. Do not have a front, burr and other bad. The maximum chamfering cut point of pipe mouth should not exceed 0.03mm.
 3. Black, yellow, fog and other undesirable phenomena are not allowed.

Order Information:
 L-KLS1-2172-04-Sn-1.0×1.9×24.0
 L: RoHS
 Series
 Plating: Sn Plating
 Dimensions: 1.0×1.9×24.0mm

| | | | | |
|-------------------|------------|--------------|-------------------------------|---------------------------------|
| ANGLE TOLERANCE | PROJECTION | Description: | Double needle (Copper Pillar) | |
| ±3° | | | | |
| GENERAL TOLERANCE | UNITS | mm | KLS P/N: | L-KLS1-2172-04-Sn-1.0×1.9×24.0 |
| x.x ±0.30 | SHEET SIZE | A4 | | |
| x.xx ±0.20 | Draw: | Daniel | 2022-08-15 | NingBo KLS ELECTRONIC CO.,L TD. |
| x.xxx ±0.10 | Check: | Daniel | 2022-08-15 | |