

List numbers & Dimensions

Off-set tags
2-hole fixing

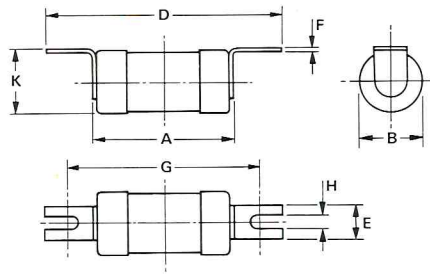

Type	Rating Amp	List number	Dimensions in millimetres								
			A	B	D	E	F	G Fixing centres	H	K	
NIT 2-20 Amp	2	NIT2									
Extended Motor Range 20M25 & 20M32†	4	NIT4									
	6	NIT6									
	10	NIT10	36.50	14.10	55.60	11.10	0.80	44.50	4.70	14.30	
	16	NIT16	BS 88:1988 Dimensional Ref. A1								
	20	NIT20									
	20M25	NIT20M25†									
	20M32	NIT20M32†									

Off-set tags
2-hole fixing

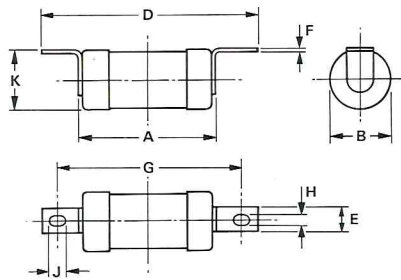

Type	Rating Amp	List number	Dimensions in millimetres								
			A	B	D	E	F	G Fixing centres	H	J	K
TIA 2-32 Amp	2	TIA2									
Extended Motor Range 32M35 - 32M63†	4	TIA4									
	6	TIA6									
	10	TIA10									
	16	TIA16									
	20	TIA20	56.40	23.80	85.80	8.70	1.20	73.00	5.20	8.10	24.90
	25	TIA25	BS 88:1988 Dimensional Ref. A2								
	32	TIA32									
	32M35	TIA32M35†									
	32M40	TIA32M40†									
	32M50	TIA32M50†									
32M63	TIA32M63†										
TIS 35-63 Amp	35	TIS35									
Extended Motor Range 63M80 - 63M100†	40	TIS40	56.40	23.80	85.80	8.70	1.20	73.00	5.20	8.10	24.90
	50	TIS50									
	63	TIS63									
	63M80	TIS63M80†	†58.00	26.20	90.50	12.70	1.20	73.00	5.20	7.50	27.80
	63M100	TIS63M100†	BS 88:1988 Dimensional Ref. A3								
TCP 80 & 100 Amp	80	TCP80	58.00	26.20	111.00	19.10	2.40	93.70	8.70	11.90	27.50
Extended Motor Range 100M125 - 100M200†	100	TCP100									
	100M125	TCP100M125†	†70.00	34.90	111.00	19.10	2.40	93.70	8.70	11.90	34.90
	100M160	TCP100M160†	BS 88:1988 Dimensional Ref. A4								
	100M200	TCP100M200†									
TFP 125-200 Amp	125	TFP125									
	160	TFP160	70.00	34.90	111.00	19.10	2.40	93.70	8.70	11.90	34.90
	200	TFP200									

† Fuse links from the Extended Range for Motor Circuits - See pages 1/7 & 1/13.