

1. Features

- 1.Excellent solderability and high heat resistance.
- 2.Excellent terminal strength construction.
- 3.Packed in embossed carrier tape and can be used by automatic mounting machine.
- 4.100% Lead(Pb) & Halogen-Free and RoHS compliant.

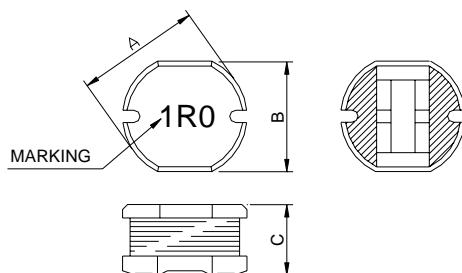

2. Dimension



Size	A(mm)	B(mm)	C(mm)
FPI 0502	5.80±0.3	5.20±0.3	2.00±0.3

3. Part Numbering

FPI
0502
F
-
4R7
M

A B C D E

A: Series

B: Dimension

C: Lead free type

D: Inductance

4R7=4.7uH, 470=47uH, 471=470uH

E: Inductance Tolerance

M=±20%

4. Specification

Customer Part Number	TAI-TECH Part Number	Inductance (uH)	Tolerance (%)	Test Frequency (Hz)	DCR (Ω) max.	IDC (A) max.
	FPI 0502F-1R0M	1.0	± 20%	1V/7.96M	0.03	1.50
	FPI 0502F-1R4M	1.4	± 20%	1V/7.96M	0.04	1.50
	FPI 0502F-1R8M	1.8	± 20%	1V/7.96M	0.05	1.50
	FPI 0502F-2R2M	2.2	± 20%	1V/7.96M	0.06	1.50
	FPI 0502F-2R7M	2.7	± 20%	1V/7.96M	0.07	1.50
	FPI 0502F-3R3M	3.3	± 20%	1V/7.96M	0.08	1.50
	FPI 0502F-3R9M	3.9	± 20%	1V/7.96M	0.09	1.00
	FPI 0502F-4R7M	4.7	± 20%	1V/7.96M	0.10	1.00
	FPI 0502F-5R6M	5.6	± 20%	1V/7.96M	0.11	1.00
	FPI 0502F-6R8M	6.8	± 20%	1V/7.96M	0.14	0.70
	FPI 0502F-8R2M	8.2	± 20%	1V/7.96M	0.15	0.65
	FPI 0502F-100M	10	± 20%	1V/2.52M	0.30	0.60
	FPI 0502F-120M	12	± 20%	1V/2.52M	0.35	0.60

Customer Part Number	TAI-TECH Part Number	Inductance (uH)	Tolerance (%)	Test Frequency (Hz)	DCR (Ω) max.	IDC (A) max.
	FPI 0502F-150M	15	$\pm 20\%$	1V/2.52M	0.40	0.55
	FPI 0502F-180M	18	$\pm 20\%$	1V/2.52M	0.45	0.50
	FPI 0502F-220M	22	$\pm 20\%$	1V/2.52M	0.50	0.50
	FPI 0502F-270M	27	$\pm 20\%$	1V/2.52M	0.55	0.45
	FPI 0502F-330M	33	$\pm 20\%$	1V/2.52M	0.60	0.40
	FPI 0502F-390M	39	$\pm 20\%$	1V/2.52M	0.70	0.35
	FPI 0502F-470M	47	$\pm 20\%$	1V/2.52M	0.80	0.30
	FPI 0502F-560M	56	$\pm 20\%$	1V/2.52M	0.90	0.25
	FPI 0502F-680M	68	$\pm 20\%$	1V/2.52M	1.20	0.25
	FPI 0502F-820M	82	$\pm 20\%$	1V/2.52M	1.50	0.22
	FPI 0502F-101M	100	$\pm 20\%$	1V/1K	2.00	0.21
	FPI 0502F-121M	120	$\pm 20\%$	1V/1K	3.00	0.20
	FPI 0502F-151M	150	$\pm 20\%$	1V/1K	4.00	0.18
	FPI 0502F-181M	180	$\pm 20\%$	1V/1K	4.00	0.15
	FPI 0502F-221M	220	$\pm 20\%$	1V/1K	4.50	0.15
	FPI 0502F-271M	270	$\pm 20\%$	1V/1K	5.00	0.15
	FPI 0502F-331M	330	$\pm 20\%$	1V/1K	6.00	0.14
	FPI 0502F-391M	390	$\pm 20\%$	1V/1K	6.50	0.14
	FPI 0502F-471M	470	$\pm 20\%$	1V/1K	7.00	0.12
	FPI 0502F-561M	560	$\pm 20\%$	1V/1K	8.00	0.12